



1 St. Josephs Close, Kettering NN15 5DY
£279,950

A "Drury" built three bedroom semi detached home set on a corner plot with off road parking. The property has been EXTENDED to the side and offers versatile and family orientated accommodation that comprises of hall, lounge, dining room, conservatory, kitchen, bathroom/wc, landing, three bedrooms and en suite shower/wc to bedroom one. Located in a highly desirable area on the south side of town being close to open countryside. Many local amenities to include schools, shops, Wicksteed Park and bus routes. Kettering town center and train station are all within easy reach. Viewing recommended.

Tenure: Freehold
Energy Rating: D
Council Tax Band: B

LUCAS
SALES & LETTINGS

GROUND FLOOR
638 sq.ft. (59.3 sq.m.) approx.

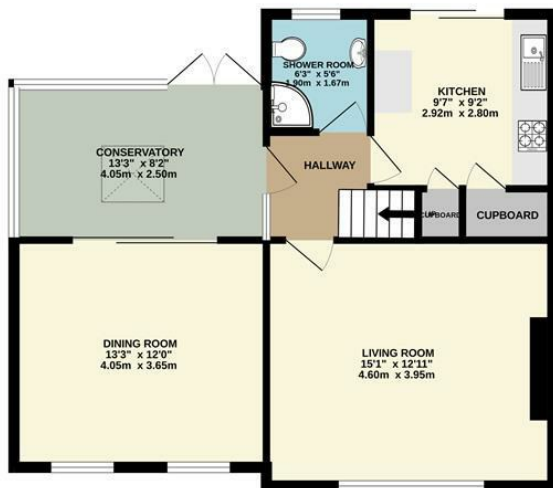

1ST FLOOR
361 sq.ft. (33.6 sq.m.) approx.



TOTAL FLOOR AREA: 1000 sq.ft. (92.9 sq.m.) approx.

Whilst every attempt has been made to ensure the accuracy of the floorplan contained here, measurements of doors, windows, rooms and any other items are approximate and no responsibility is taken for any error, omission or mis-statement. This plan is for illustrative purposes only and should be used as such by any prospective purchaser. The services, systems and appliances shown have not been tested and no guarantee as to their operability or efficiency can be given.
Made with Mergex ©2005

- No Upward Chain
- Extended
- Three Bedrooms
- Corner Plot
- Double Glazed
- Gas Central Heating

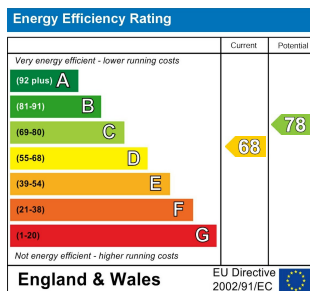

2 Silver Street, Kettering,
Northamptonshire, NN16 0BN
Tel: 01536 312 600

sales@lucasestateagents.co.uk

Important: We would like to inform prospective purchasers that these sales particulars have been prepared in good faith as a general guide only. A survey has not been carried out, nor the services, appliances and fittings tested. All measurements are approximate; sizes should not be relied upon for furnishing, or any other purposes. Floor plans are for guidance and illustration purposes only and are not to scale. Photos are taken with a wide angle lens. Items shown in the photographs are expressly excluded unless agreed otherwise in writing. If there are any matters likely to affect your decision to buy, please contact us before viewing the property and clarify all matters prior to offer. L786

LUCAS
SALES & LETTINGS